

Write your serial # here:



IMPORTANT:
Please write down serial #
located on back of terminal
before mounting.

TimeTrax™ Time and Attendance Software on a Server or Virtual Machine.
Server or Virtual Machine. Pyramid Time Systems does not support the use
of TimeTrax™ software on a Server or Virtual Machine.

- English:** Regional setting and hardware input in English
- ADMIN:** Must be the primary Admin to install software
- Windows:** Windows 10 or greater
All Windows updates must be installed prior to software installation
- Browser:** Updated Chrome or Firefox
- Memory:** 8GB RAM minimum, 16GB recommended
- PC:** X64 Pentium IV 2.0 GHz or greater
- Free Space:** 20GB or greater

Software Requirements



- What you will need.**
- Tape Measure
 - Pencil
 - Phillips Head Screw Driver
 - Power Drill (Optional)

- Contents**
- 9600 Terminal
 - Power Supply
 - Ethernet Cable (CAT5)
 - Security Bracket & Key
 - TTEliteek Quick Start Guide

Contents



Call us
888.479.7264



Send us an email
customer_support@ptitime.com



TIMETRAX™ Elite· Bio ek
Biometric Time Clock System
TTEliteek

9600
Quick Start Guide
SIMPLE : SMART





Connect Terminal

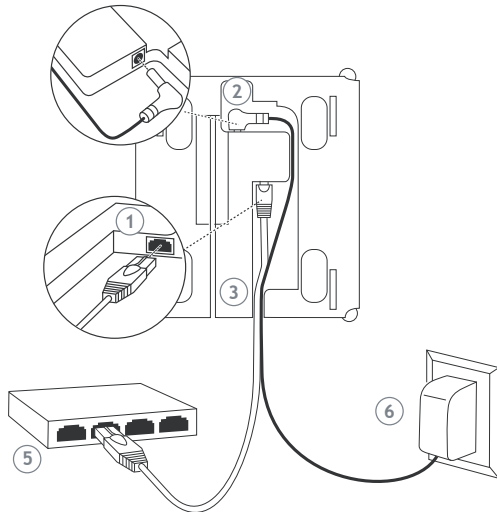

- 1 Connect either end of Ethernet cable into "ETHERNET" port located on the back of time clock terminal.
- 2 Connect power supply into "POWER" port located in compartment on back of terminal.
- 3 Route the cables through channel at base of terminal.
- 4 Mount terminal (see instructions below).
- 5 Plug free end of Ethernet cable into a DHCP network jack, router or switch.
- 6 Plug power supply into outlet.

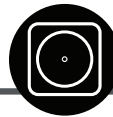

Download TimeTrax™ Software

TimeTrax™ Software Download Information

For TimeTrax™ Version 5 software information please call 888 479-7264, ext. 800 or send email to customer_support@ptitime.com



TimeTrax™ Instructional Videos

Follow the instructions below to view our setup videos

- 1 In your web browser type in the following URL: pyramidtimesystems.com/resources/videos
- 2 Scroll down to *TimeTrax Time and Attendance Software* and start with the *HARDWARE MANAGER* video



Mount Terminal

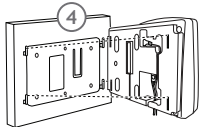

To mount terminal

- Install mounting bracket using mounting screws provided. "TOP" is engraved to ensure bracket is oriented correctly and the tabs face upward.
- Additional holes are provided if mounting onto an electrical box.
- Push terminal onto mounting bracket aligning four tabs on bracket with four matching slots on back of terminal. Be sure to write down the terminal serial number before mounting.
- Slide terminal downward until locking tab clicks into place. When properly mounted, terminal cannot be removed from the bracket without using the included wall bracket release key to disengage locking tab.
- Cables may be routed through channel at base of terminal or by drilling a hole in the rectangular section of the mounting bracket and through the wall for concealing cables.

To detach terminal

- Insert key (tab facing outward) into narrow slot located on bottom of terminal to right of cable access cutout.
- Push key all the way up into slot. Key will slide easily until last 1/2 inch until some resistance from locking tab is felt.
- With key fully pushed into slot, slide the terminal up and off mounting bracket.



Using Time Clock

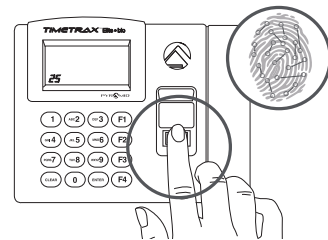

IMPORTANT: Before using time clock, please register employee fingerscans at the time clock terminal.

Instructions may be accessed by clicking "HELP" from main toolbar, or click "F1" for help on a specific screen. Please reference "Fingerscan Registration (TTELITEEK)" section.

Place finger on lit finger pad.

If finger scan is successfully read, the scanner light will briefly go out, the time clock terminal will beep and the employee number will be displayed on terminal screen.

Technical Support and Warranty information:
pyramidtimesystems.com/support/warranty-and-return/